

Wolfson Education Centre

The Wolfson Conference Centre has long served as a major focus for postgraduate educational needs at the Hammersmith Campus and, as part of Imperial's significant over-arching scheme to redevelop the eastern half of this campus, the College will transform the centre into a redesigned and fully renovated Wolfson Education Centre.

The Wolfson Education Centre has been made possible by a recently awarded and most generous grant of £2 million from the Wolfson Foundation. Significant additional funding towards the project's total cost of approximately £5 million has also been committed by the College.

The centre will provide a new home for a graduate entry medicine course. With an annual intake of 50 top-class graduates, the four-year course will be grounded in the General Medical Council's recommendations published in *Tomorrow's Doctors*. The programme aims to provide graduates with the scientific and clinical knowledge, skills and attitudes that doctors practising in the twenty-first century will need.

A new three-year BSc in Biomedical Science, with an annual intake of 50 top-quality students each year, will also be a key beneficiary of the new facilities. The innovative course will draw on Imperial's great research strengths to produce graduates who are ideally equipped to follow a research career and become the biomedical research leaders of the future.

The incredible support received over the years by the College from the Wolfson Foundation is, at least in part, evidenced by the history of this important educational facility. In 1957 the Foundation made a grant of £125,000 to provide for the original construction costs of the centre – a fantastically

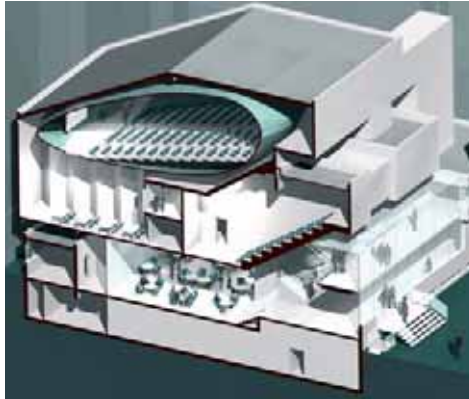

Artist's impression of the Wolfson Education Centre

generous donation at the time – and has kindly provided funds on a number of occasions for refurbishment over its lifespan of almost 50 years. However, needs evolve and the current plans for a complete refurbishment will deliver the outstanding environment Imperial needs to create for expanded educational programmes and our doctors of the future.

The centre currently houses the Stamp Lecture Theatre which will be transformed through the introduction of a mezzanine floor. This will effectively create a new state-of-the-art lecture theatre with a capacity of 250 people at the top of the building. 'New' space will be created below this to house a run of highly flexible seminar rooms which can be combined or used independently.

Professor Stephen Smith, Principle of the Faculty of Medicine, said: "The Wolfson Education Centre is a central part of our vision for the Hammersmith Campus. It will be our communication hub – a centre that will bring together our brightest and best minds to share ideas, and educate our next generation of doctors and researchers."

The project is scheduled for completion in advance of the Faculty of Medicine's first intake of graduate entry medical students in 2008–09, but the reality is that undergraduates, postgraduates, researchers, industry and healthcare professionals will all stand to benefit enormously from the redevelopment.